

MODEL D58X PUMP PARTS LIST (TWO STAGE PUMP)

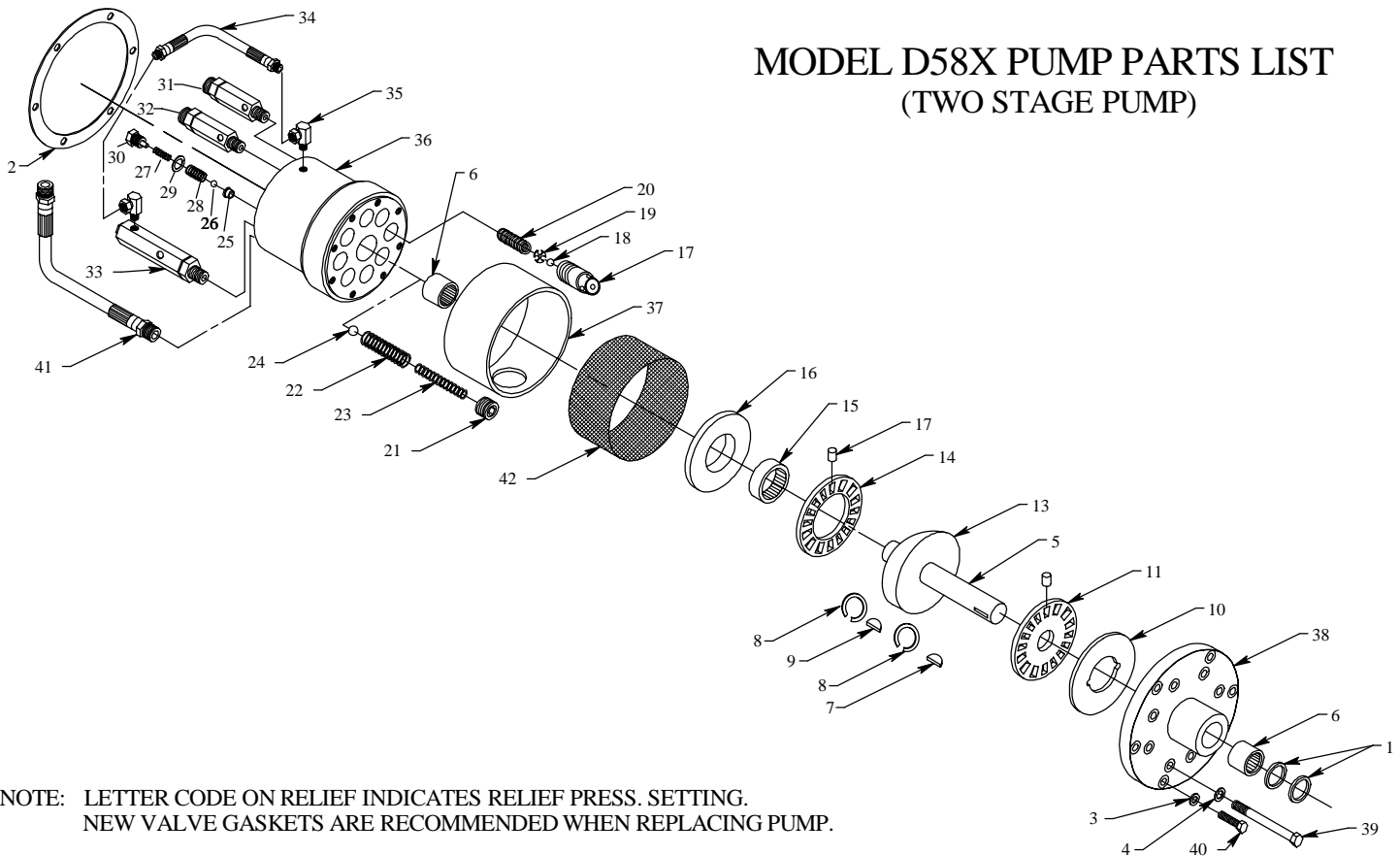

NOTE: LETTER CODE ON RELIEF INDICATES RELIEF PRESS. SETTING.
NEW VALVE GASKETS ARE RECOMMENDED WHEN REPLACING PUMP.

NO.	PART NO.	QTY. REQ.	PART DESCRIPTION	NO.	PART NO.	QTY. REQ.	PART DESCRIPTION
	1359		SEAL KIT		1355		CHECK VALVE KIT
1	1028	2	OIL SEAL	21	1221	1	PLUG
2	1012	1	PUMP GASKET	22	2383	1	CAGE SPRING
3	1030	6	ALUMINUM WASHER	23	1216	1	SPRING
4	1108	8	ALUMINUM WASHER	24	1217	1	BALL
	1358		SHAFT AND BEARING KIT		1354		EXHAUST VALVE KIT
5	1075	1	SHAFT	25	1043	8	SEAT
6	1023	2	NEEDLE BEARING	26	1015	8	BALL
7	1027	1	SHAFT KEY	27	2264	8	EXHAUST SPRING
8	1118	2	SNAP RING	28	1041	8	CAGE SPRING
9	1117	1	WOBBLE KEY	29	1009	8	WASHER
	1357		THRUST BEARING KIT	30	1008	8	PORT STUD
10	1080	1	THRUST RACE		1352		UNLOADING VALVE KIT
11	1077	1	FRONT ROLLER RETAINER	33	1245	1	UNLOADING VALVE
12	1119	32	THRUST ROLLER BEARING	34	1351	1	PILOT HOSE
13	1232	1	WOBBLE PLATE	35	1243	2	90° FITTING
14	1078	1	REAR ROLLER RETAINER				REMAINING PUMP PARTS
15	1106	1	THRUST PLATE BEARING	31	2663	1	LOW PRESS. RELIEF } SPECIFY PUMP MODEL, HIGH PRESS. RELIEF } SERIAL#, PRESSURE & R.P.M.)
16	1076	1	PISTON THRUST PLATE	32	1087	1	
	1356		PISTON KIT	36	1238	1	PUMP CASTING (Not Sold Separately)
17	1235	8	PISTON	37	1237	1	INTAKE HOUSING TUBE
18	1168	8	BALL	38	1350	1	FRONT CASTING
19	1233	8	BALL STOP	39	1107	8	PUMP ASSEMBLY BOLT
20	1234	8	SPRING	40	1035	6	MOUNTING CAP SCREW
				41	--		HOSE - SPECIFY RESERVOIR SIZE WHEN ORDERING
				42	1515	1	INTAKE SCREEN