

# MODEL F98X PUMP PARTS LIST (TWO STAGE PUMP)

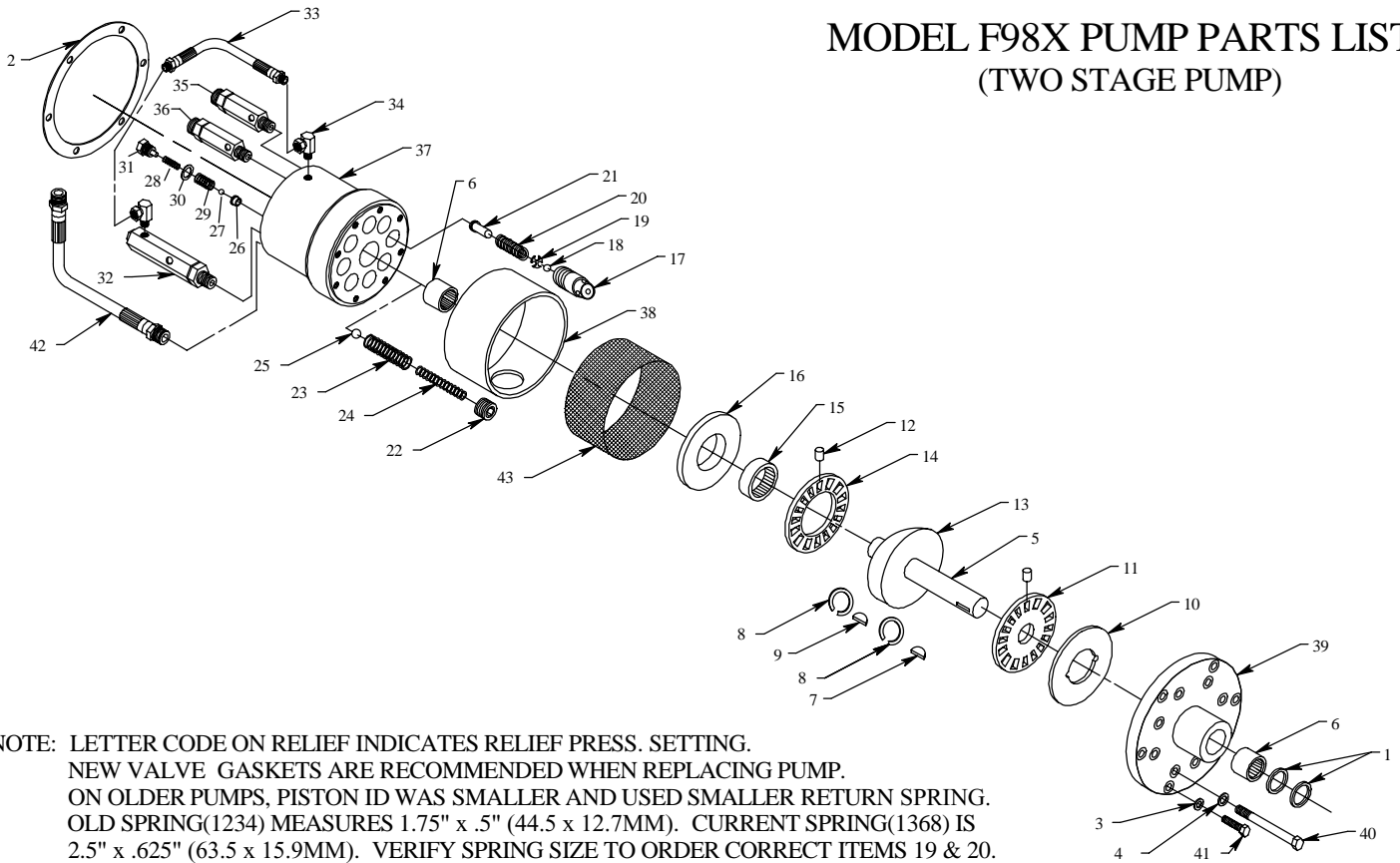

NO.	PART NO.	QTY. REQ.	PART DESCRIPTION	NO.	PART NO.	QTY. REQ.	PART DESCRIPTION
	<b>1359</b>		<b>SEAL KIT</b>		<b>1355</b>		<b>CHECK VALVE KIT</b>
1	1028	2	OIL SEAL	22	1221	1	PLUG
2	1012	1	PUMP GASKET	23	2383	1	CAGE SPRING
3	1030	6	ALUMINUM WASHER	24	1216	1	SPRING
4	1108	8	ALUMINUM WASHER	25	1217	1	BALL
	<b>1358</b>		<b>SHAFT AND BEARING KIT</b>		<b>1354</b>		<b>EXHAUST VALVE KIT</b>
5	1075	1	SHAFT	26	1043	8	SEAT
6	1023	2	NEEDLE BEARING	27	1015	8	BALL
7	1027	1	SHAFT KEY	28	2264	8	EXHAUST SPRING
8	1118	2	SNAP RING	29	1041	8	CAGE SPRING
9	1117	1	WOBBLE KEY	30	1009	8	WASHER
	<b>1360</b>		<b>THRUST BEARING KIT</b>	31	1008	8	PORT STUD
10	1080	1	THRUST RACE		<b>1352</b>		<b>UNLOADING VALVE KIT</b>
11	1077	1	FRONT ROLLER RETAINER	32	1245	1	UNLOADING VALVE
12	1119	32	THRUST ROLLER BEARING	33	1351	1	PILOT HOSE
13	1131	1	WOBBLE PLATE	34	1243	2	90° FITTING
14	1078	1	REAR ROLLER RETAINER				<b>REMAINING PUMP PARTS</b>
15	1106	1	THRUST PLATE BEARING	35	2663	1	LOW PRESS. RELIEF } SPECIFY PUMP MODEL,
16	1076	1	PISTON THRUST PLATE	36	1087	1	HIGH PRESS. RELIEF } SERIAL#, PRESSURE & R.P.M.)
	<b>1361</b>		<b>PISTON KIT</b>	37	1242	1	PUMP CASTING (Not Sold Separately)
17	1367	8	PISTON	38	1237	1	INTAKE HOUSING TUBE
18	1168	8	BALL	39	1350	1	FRONT CASTING
19	1366	8	BALL STOP (1233 for old pumps, see note)	40	1107	8	PUMP ASSEMBLY BOLT
20	1368	8	SPRING (1234 for old pumps, see note)	41	1035	6	MOUNTING CAP SCREW
21	1369	8	SPRING PIVOT	42	--		HOSE - SPECIFY RESERVOIR SIZE WHEN ORDERING
				43	1515	1	INTAKE SCREEN